

Cap End (20 Nov)

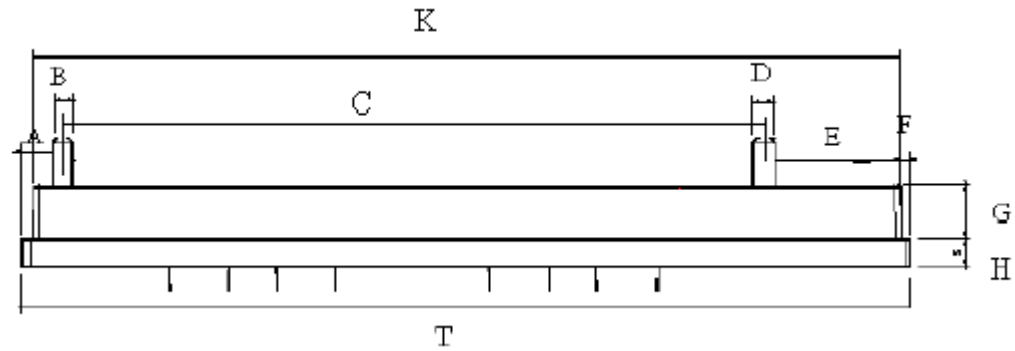

(mm)	Measures	Expectation
A	6,67	6,9
B	3,48	3,5
C	121,29	120,8
D	3,40	3,5
E	23,59	21,57
F	1,58	2
G	9,32	9,5
H	5,02	5
T	153,29	153
K	150,41	150,8
L	16,87	17
Z	0,16	0

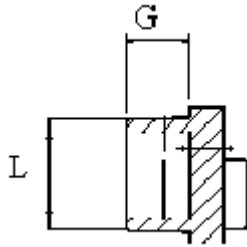